

N:\IDA\13120-00_Tomball W Main Retail\CAD\PRELIM\13120-00_site_131112.dwg plotted by William Kalkman on 2013-11-13 at 4:13 PM

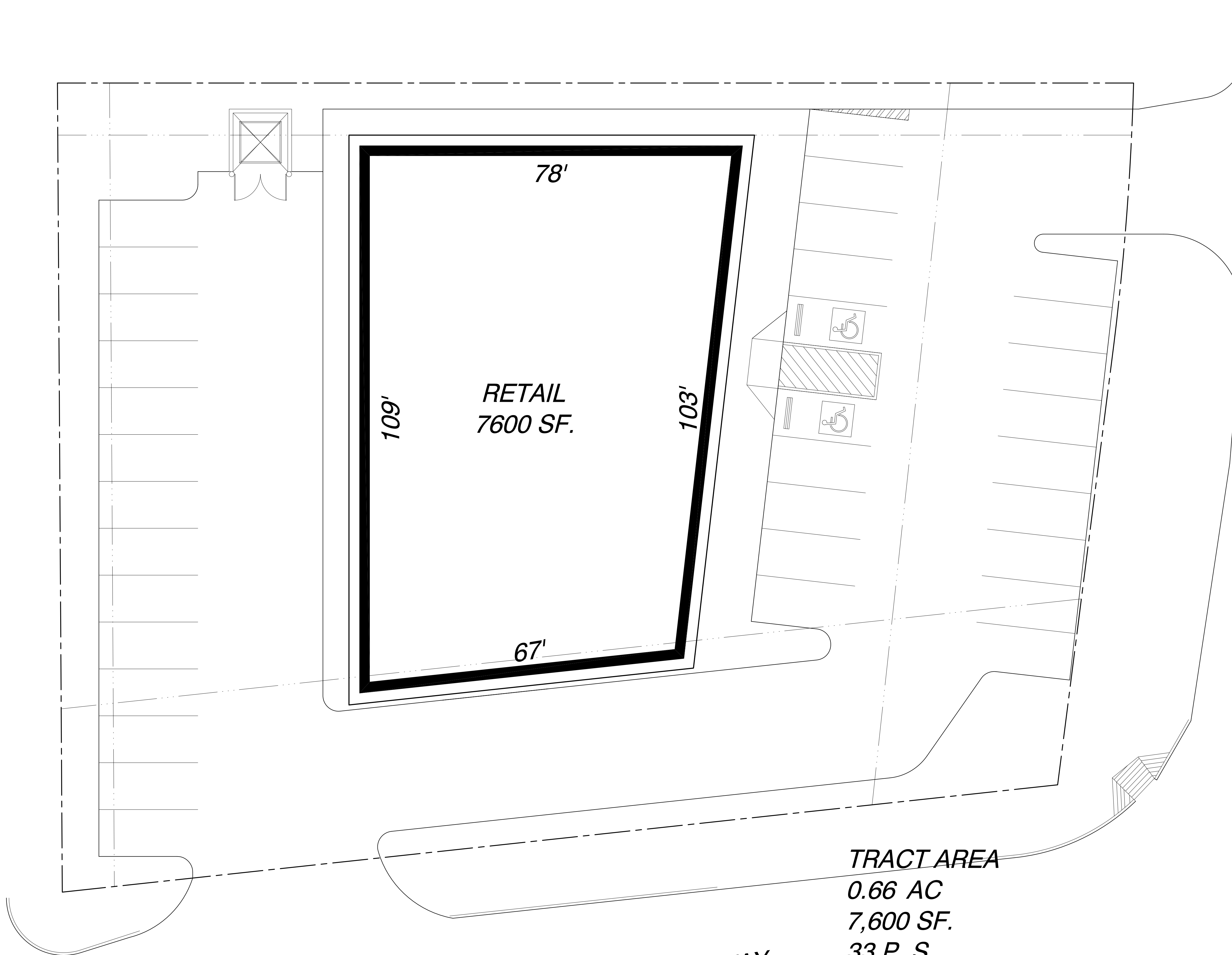

RETAIL
7600 SF.

109'

78'

103'

67'

WEST MAIN

TOMBALL PARKWAY

TRACT AREA
 0.66 AC
 7,600 SF.
 33 P. S.
 4.34 P.S. /1K SF.

SCHEME 11

November 12, 2013
 a master schematic development plan for
STATE HIGHWAY 249
AT F.M. 2920 (W. MAIN ST.)
TOMBALL , TX
 prepared for

BAKER | KATZ

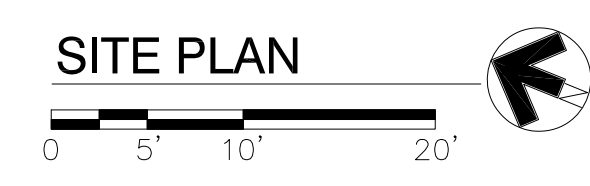

identityARCHITECTS
 111 Travis St., Houston, TX 77002
 V. 713.595.2150 • F. 713.595.2198

13120-00_site_131112.dwg 4:13 PM
 THIS DRAWING IS FOR PRESENTATION PURPOSES ONLY. ANY AND ALL FEATURES, MATTERS AND OTHER INFORMATION DEPICTED HEREON OR CONTAINED HEREIN ARE FOR ILLUSTRATIVE MARKETING PURPOSES ONLY, ARE SUBJECT TO MODIFICATION WITHOUT NOTICE, ARE NOT INTENDED TO BE RELIED UPON BY ANY PARTY AND ARE NOT INTENDED TO CONSTITUTE REPRESENTATIONS AND WARRANTIES AS TO THE SIZE AND NATURE OF IMPROVEMENTS TO BE CONSTRUCTED (OR THAT ANY IMPROVEMENTS WILL BE CONSTRUCTED) OR AS TO THE IDENTITY OR NATURE OF ANY OCCUPANTS THEREOF.